

Flanged Three-way Ball Valve

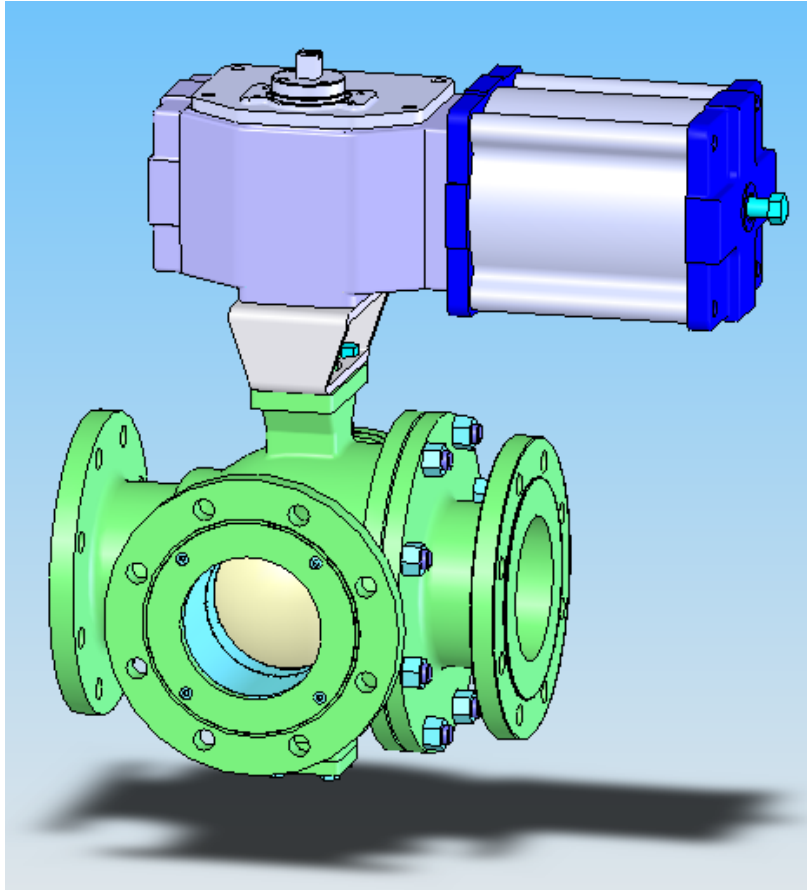

Features

1. Designed in three-seat sealing, the three-way ball valve enjoys compact structure, well configuration and favorable sealing performance. The switching of flow direction of the medium can be realized in the pipeline. Furthermore, it also can make two perpendicular passages through or closed.
2. Designed in four-seat sealing, the three-way ball valve enjoys reasonable, compact structure and well configuration. The valve not only realizes the switching of flow direction of the medium in the pipeline, but also makes three passages through one another or closes any one of the passages while the other one remains through to realize the flexible control of concurrent or split flow of the medium in the pipeline.



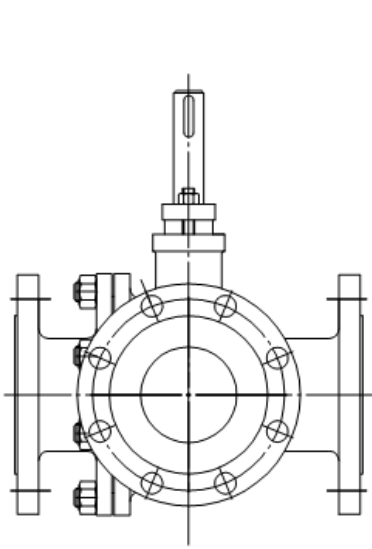

Floating Type
 Valve Size <DN100

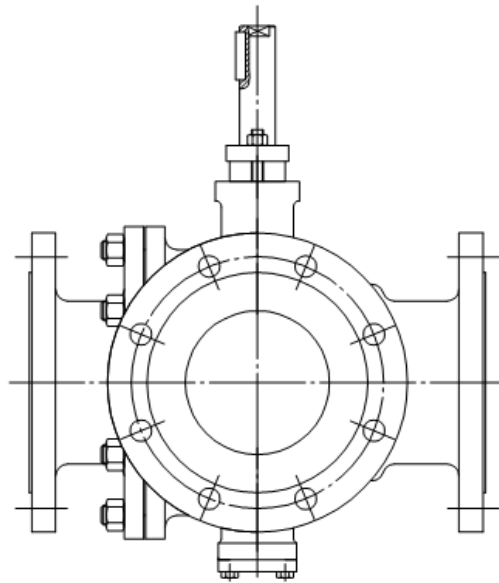

Trunnion Mounted Type
 Valve Size ≥DN 100

Main Part Material

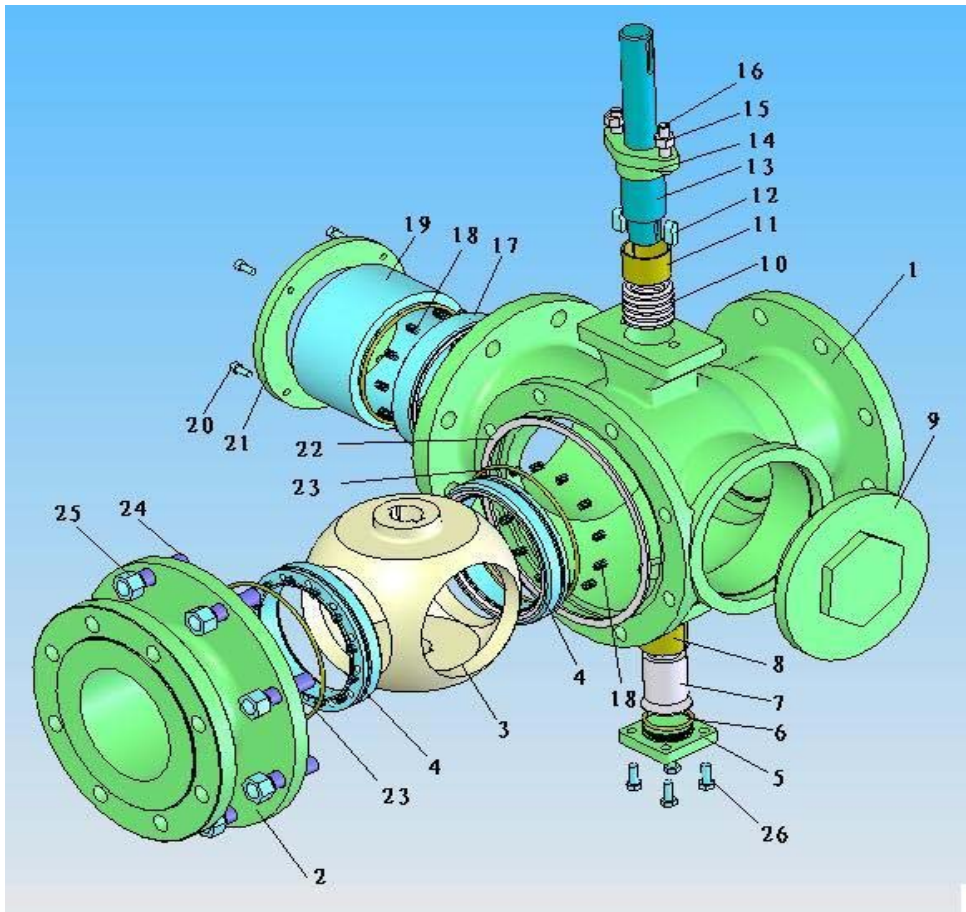

NO.	NAME	QTY (pcs)	MATERIAL	REMARK
1	Body	1	WCB. CF8. CF8M	
2	Bonnet	1	WCB. CF8. CF8M	
3	Ball	1	WCB. CF8+ HCr/ STL	
4	Seat	2	SS304, SS316+HCr/ STL	
5	Blind Flange	1	WCB. CF8. CF8M	
6	O-ring	1	EPDM, Viton	
7	Shaft	1	SS304. SS316, 20Cr13, 17-4PH	
8	Self-lubricating Bearing	1	Composite material	
9	Cover	1	WCB. CF8. CF8M	
10	Packing	1group	PTFE	
11	Self-lubricating Bearing	1	Composite material	
12	Flat Key	2	45#, SS304, SS316	
13	Shaft	1	SS304. SS316, 20Cr13, 17-4PH	
14	Packing Gland	1	WCB. CF8. CF8M	
15	Stud	2	SS304	
16	Hexagon Nut	2	SS304	
17	Seat	1	SS304, SS316+ HCr/ STL	
18	Spring	Per required	17-4PH, X-750	
19	Supporting Ring	1	SS304. SS316	
20	Socket Head Cap Screw	Per required	SS304	
21	Retainer	1	SS304. SS31	
22	Gasket	1	PTFE	
23	O-ring	1	EPDM, Viton	
24	Stud	Per required	SS304	
25	Hexagon Nut	Per required	SS304	

Main Performance Specification

PN	Test Pressure (MPa)		
	Shell Test	HP Hydraulic Test	LP Air Tight Test
1.6	2.4	1.76	0.6
2.5	3.75	2.75	
4.0	6.0	4.4	
CLASS150	3.0	2.2	
Applicable Service	Applicable Medium	Non-corrosion medium such as Water, Oil, Gas Corrosion medium such as Acid & Alkali.	
	Applicable Temp.	-20~120℃, -20~150℃, -20~230℃ -20~350℃, -20~420℃	
Applicable Standard	Flange Connection	JB79-59, GB9113, HG20592-97, ANSI B16.5, DIN EN1092-1, JIS B2220	
	Inspection & Test	GB/T9092-99, API598, ISO 5208	

Connection & External Dimension for Flanged Three-way Ball Valve 1.6MPa:

Type	DN (mm)	Dimension (mm)									
		L	L2	D	D1	D2	b	f	Z-d	H	W
Q45F-16C (P) (R)	15	150	72	95	65	45	14	2	4-14	95	130
	20	160	80	105	75	55	14	2	4-14	110	130
	25	180	90	115	85	65	14	2	4-18	120	140
	32	200	100	135	100	78	16	2	4-18	144	180
	40	220	110	145	110	85	16	3	4-18	152	220
	50	220	120	160	125	100	16	3	4-23	182	220
	65	250	130	180	145	120	16	3	4-18	193	240
	80	290	140	195	160	135	20	3	8-18	217	270
	100	370	160	215	180	155	20	3	8-18	245	350
	125	380	190	245	210	185	22	3	8-18	282	500
	150	510	220	280	240	210	24	3	8-23	319	600
	200	580	260	335	295	265	26	3	12-23	380	1000
	250	670	310	405	355	320	30	3	12-25	460	1400
	300	720	370	460	410	375	30	3	12-25	520	1800

The above dimensions are just for reference, the detail refer to the drawing when required.

L-Port, T-Port Flow Direction Diagram

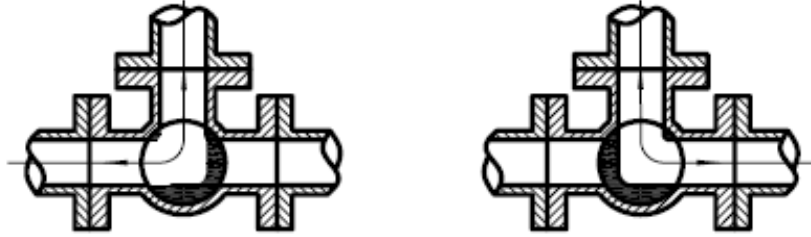

L-Port

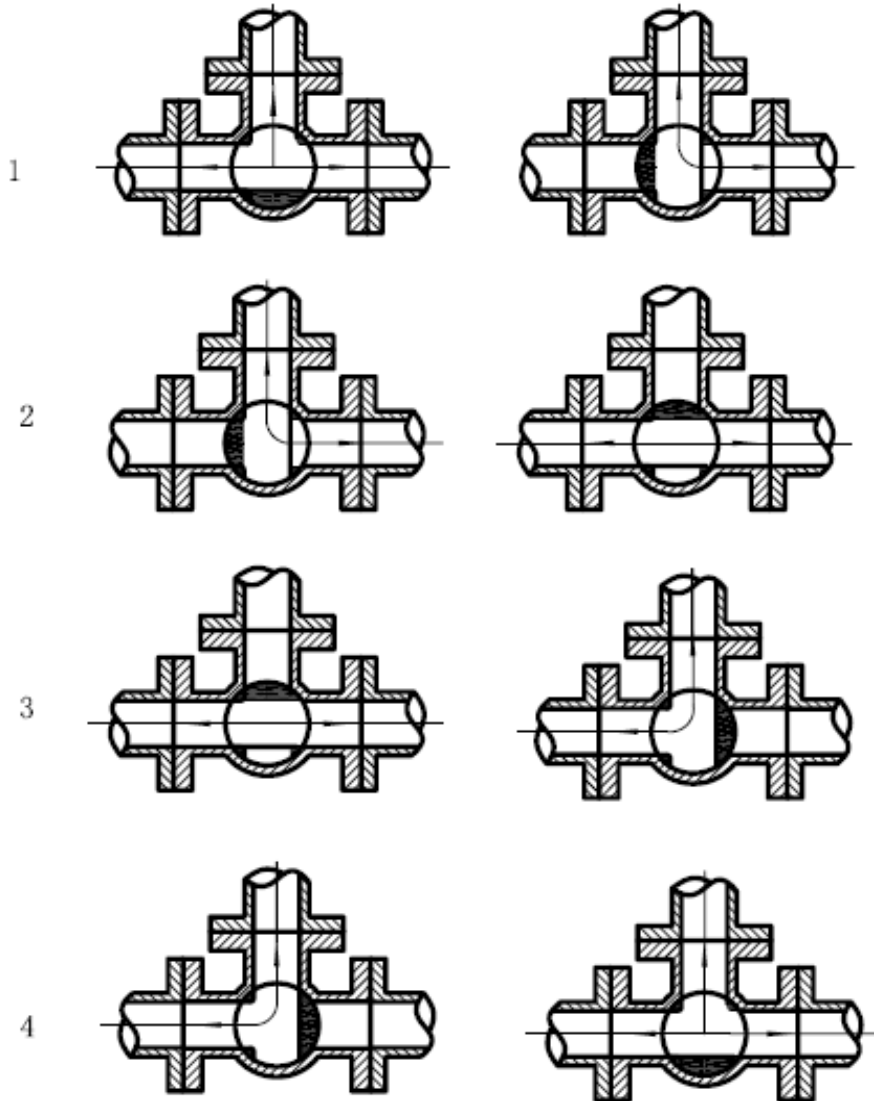

T-Port Flow Direction